

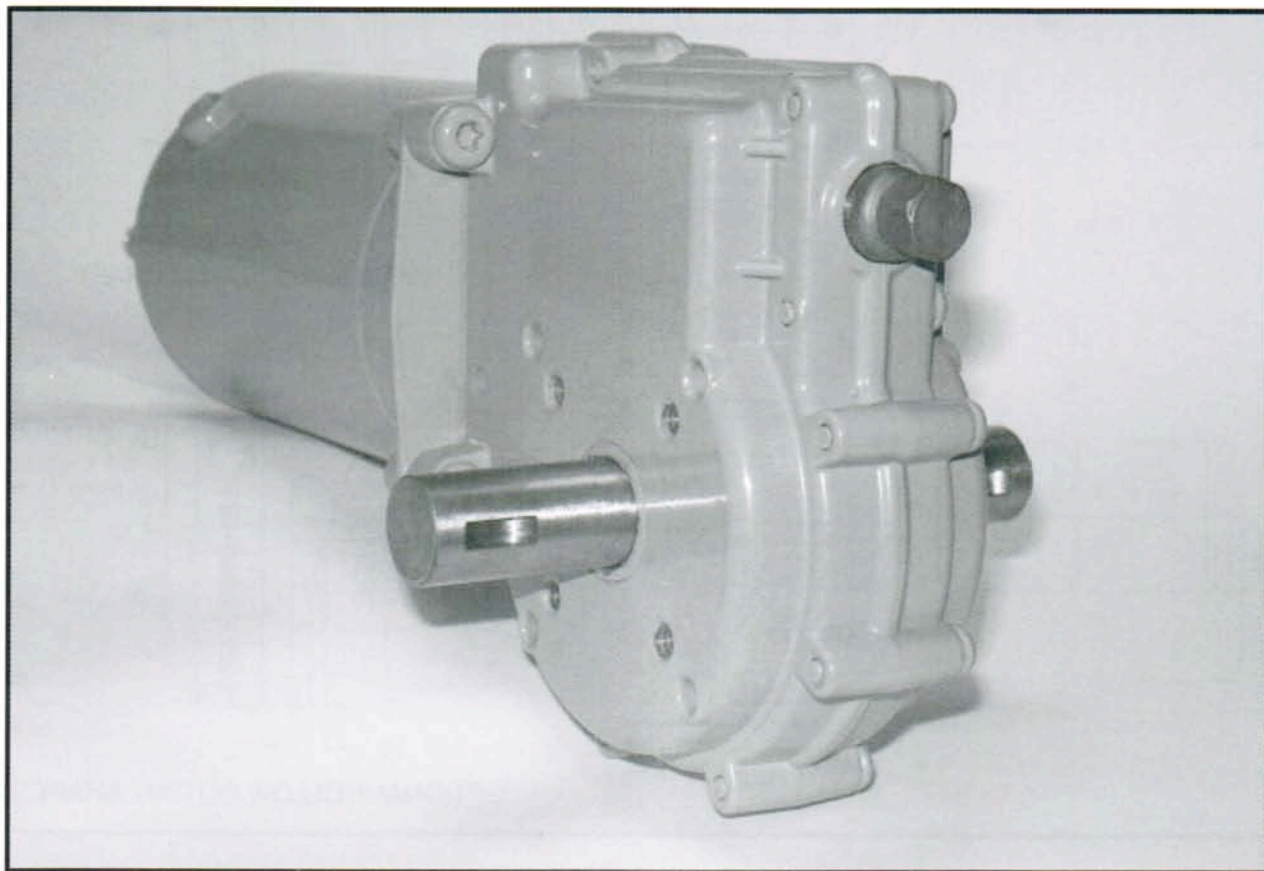

Model K175
Gearmotor
2.5 & 3.3 PMDC MOTOR



Specifications:

- 1/10–1/6 HP Ball Bearing Motors
- 12 VDC Input
- Intermittent Duty
- Reversible
- Ten Standard Ratios
- Zinc Diecast Housing
- Steel and Bronze Precision Gears
- Needle and Ball Bearings On Gear Shafts
- O–Ring Seal On Output Shaft
- Permanently Lubricated
- All Position Mount (Face–both sides)

Note: Painted finish is not standard.

Options:

- 24 and 90 VDC Input
- Lip Seal on Output Shaft
- Single Extended Output Shaft
- Hollow Output Shaft *(Sleeve Bearings Only)*
- For other options call factory

Model K175 2.5 & 3.3 TENV PMDC Motor

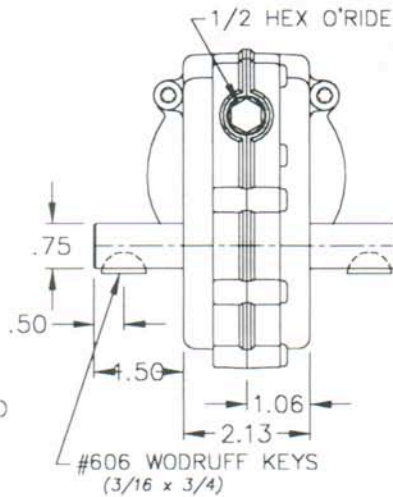
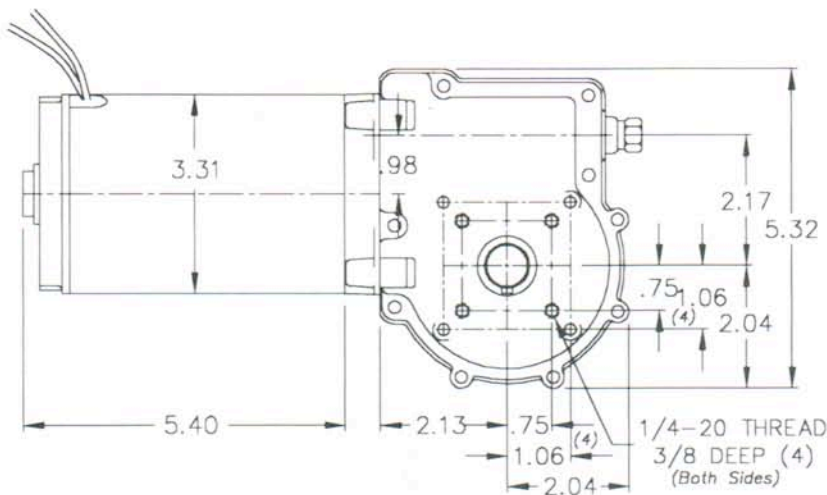

STANDARD OUTPUT SHAFT

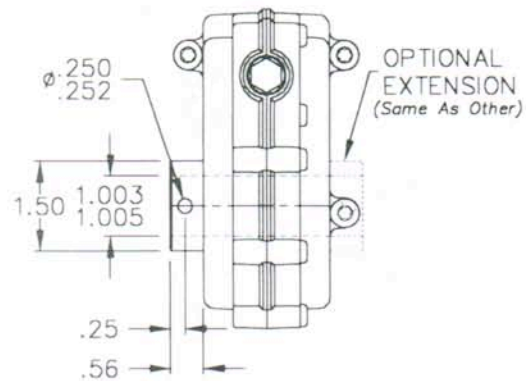
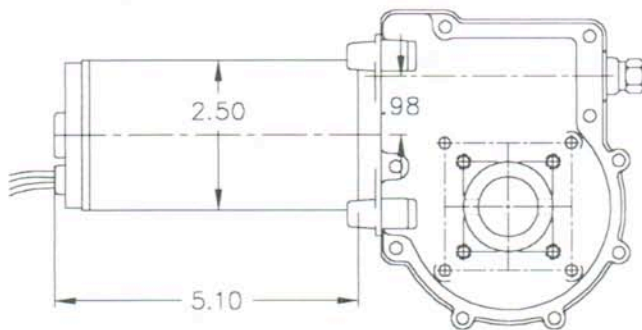

OPTIONAL HOLLOW OUTPUT SHAFT

Torque Chart (inch lbs)

PERMANENT MAGNET DC MOTOR

RATIO	3.3" 1/6 HP 2700 RPM		3.3" 1/6 HP 1900 RPM		RATIO	2.5" 1/10 HP 1800 RPM	
	FULL LOAD		FULL LOAD			FULL LOAD	
	RPM	TORQUE	RPM	TORQUE		RPM	TORQUE
*57:1	47	110	33	150	*65:1	28	110
*113:1	24	190	17	280	*130:1	14	190
227:1	12	350	8	490	260:1	7	350
266:1	10	360	7	500	305:1	6	360
306:1	9	360	6	500	351:1	5	360

*Prone to Backdrive

(Output Torque is Calculated Average and Gear Limited)

Overhung load (1" from output boss) not to exceed 300 lbs.



KLAUBER MACHINE & GEAR COMPANY

1101 GEARTECH PARKWAY

PACIFIC, MO. 63069

PH: (636) 257-3002 FAX: (636) 257-3005