

Model K350 Gearmotor 2.5 & 3.3 PMDC MOTORS

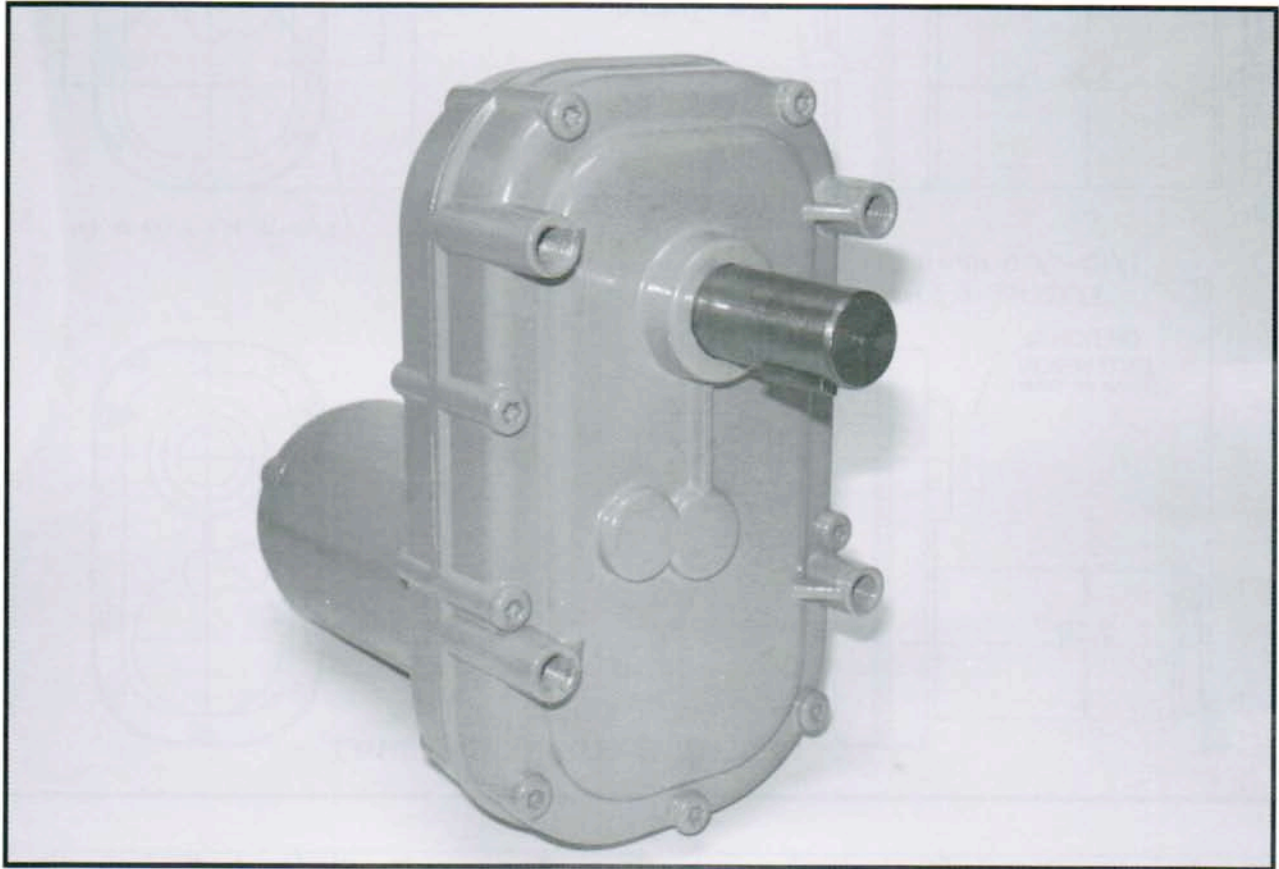

Specifications:

- Permanent Magnet Motor
- 12 VDC & 90 VDC
- Continuous & Intermittent Duty
- Reversible
- Fourteen Standard Ratios
- Zinc Diecast Housing
- Iron & Steel Precision Gears
- Needle Bearings On Gear Shafts
- O-Ring Seal On Output Shaft
- Permanently Lubricated
- All Position Mount

Options:

- Brake Mounted on Motor
- 1" ID Hollow Output Shaft
- Single Extended Output Shaft
- For other options call factory

Note: Painted finish is not standard.

Model K350 2.5 & 3.3 TENV PMDC Motors

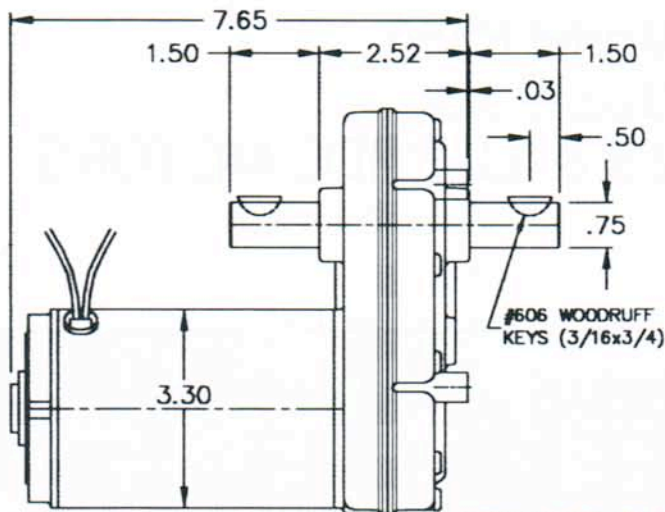

STANDARD OUTPUT SHAFT

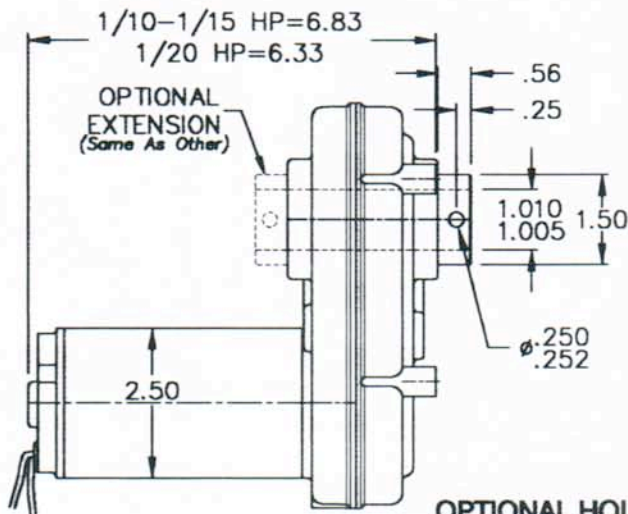
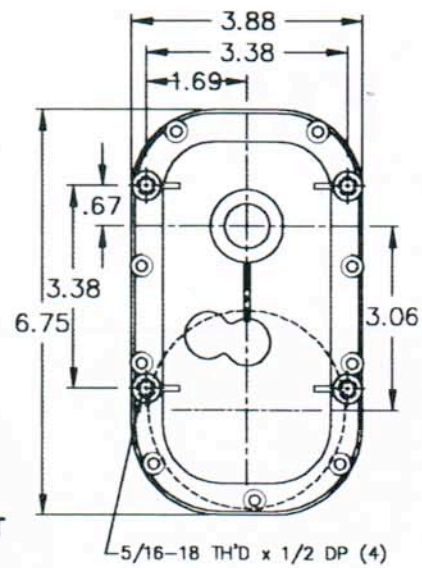

OPTIONAL HOLLOW OUTPUT SHAFT

Torque Chart (inch lbs)						
2.5" DIA PERMANENT MAGNET MOTOR						
RATIO	1/20 HP INT		1/15 HP CONT		1/10 HP INT	
	FULL LOAD		FULL LOAD		FULL LOAD	
	RPM	TORQUE	RPM	TORQUE	RPM	TORQUE
46:1	66	35	77	45	72	70
166:1	18	120	21	145	20	230
302:1	10	200	11	240	11	380
423:1	7	290	8	340	7.5	540
779:1	3.5	470	4.5	570	4	800
1104:1	2.5	670	3	800	3	800
2155:1	1.5	800	1.5	800	1.5	800

Torque Chart (inch lbs)						
3.3" DIA PERMANENT MAGNET MOTOR						
RATIO	1/8 HP CONT		1/5 HP INT		1/4 HP INT	
	FULL LOAD		FULL LOAD		FULL LOAD	
	RPM	TORQUE	RPM	TORQUE	RPM	TORQUE
39:1	52	120	47	200	63	200
142:1	14	390	12	670	17	670
255:1	8	650	7.5	800	10	800
358:1	5.5	800	5.5	800	7.5	800
649:1	3	800	3	800	4	800
920:1	2	800	2	800	3	800
1779:1	1	800	1	800	1.5	800

(Output Torque is Calculated Average and Gear Limited)
 Overhung load capacity (.75" from output boss) not to exceed 300 lbs.

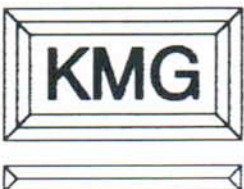

KLAUBER MACHINE & GEAR COMPANY

1101 GEARTECH PARKWAY
 PACIFIC, MO. 63069

PH: (636) 257-3002 FAX: (636) 257-3005